



图 1. 发动机操纵机构总成

Fig.1 Engine Control mechanism



图 2. 离合器总成

Fig.2 Clutch



图 3. 离合器总成 Fig.3 Clutch

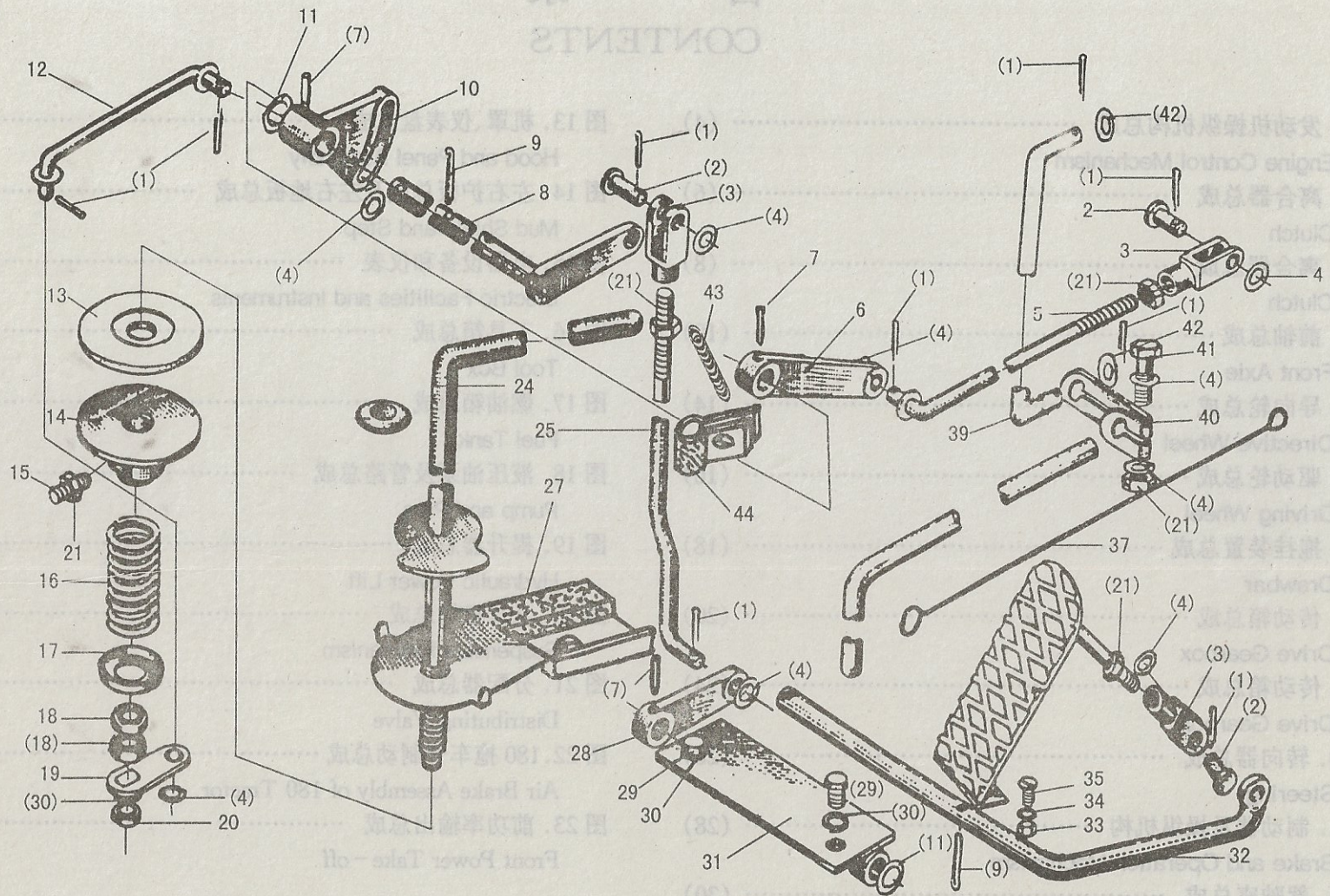

图 8. 传动箱总成

Fig.8 Drive Gearbox

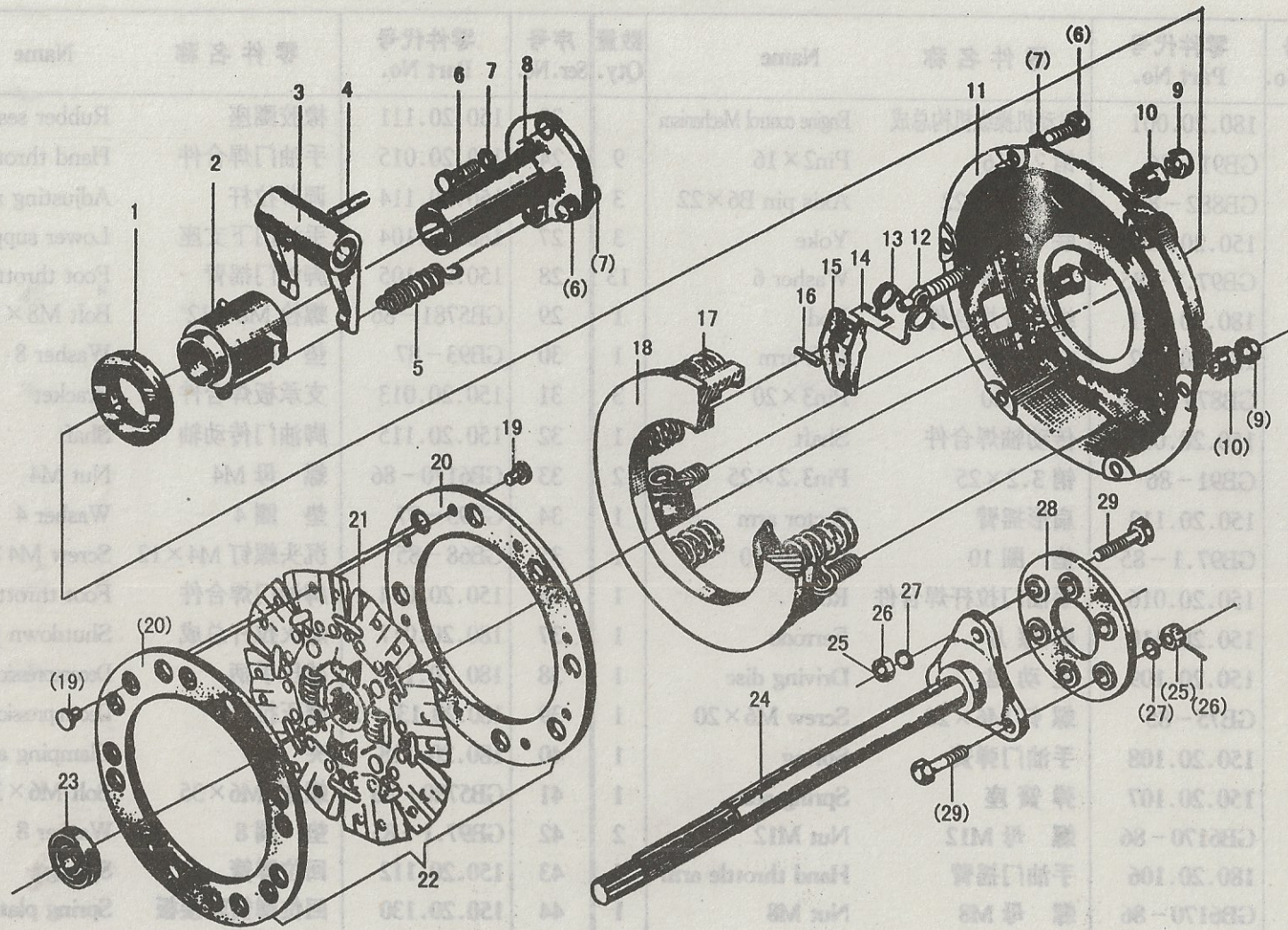

图 9. 传动箱总成

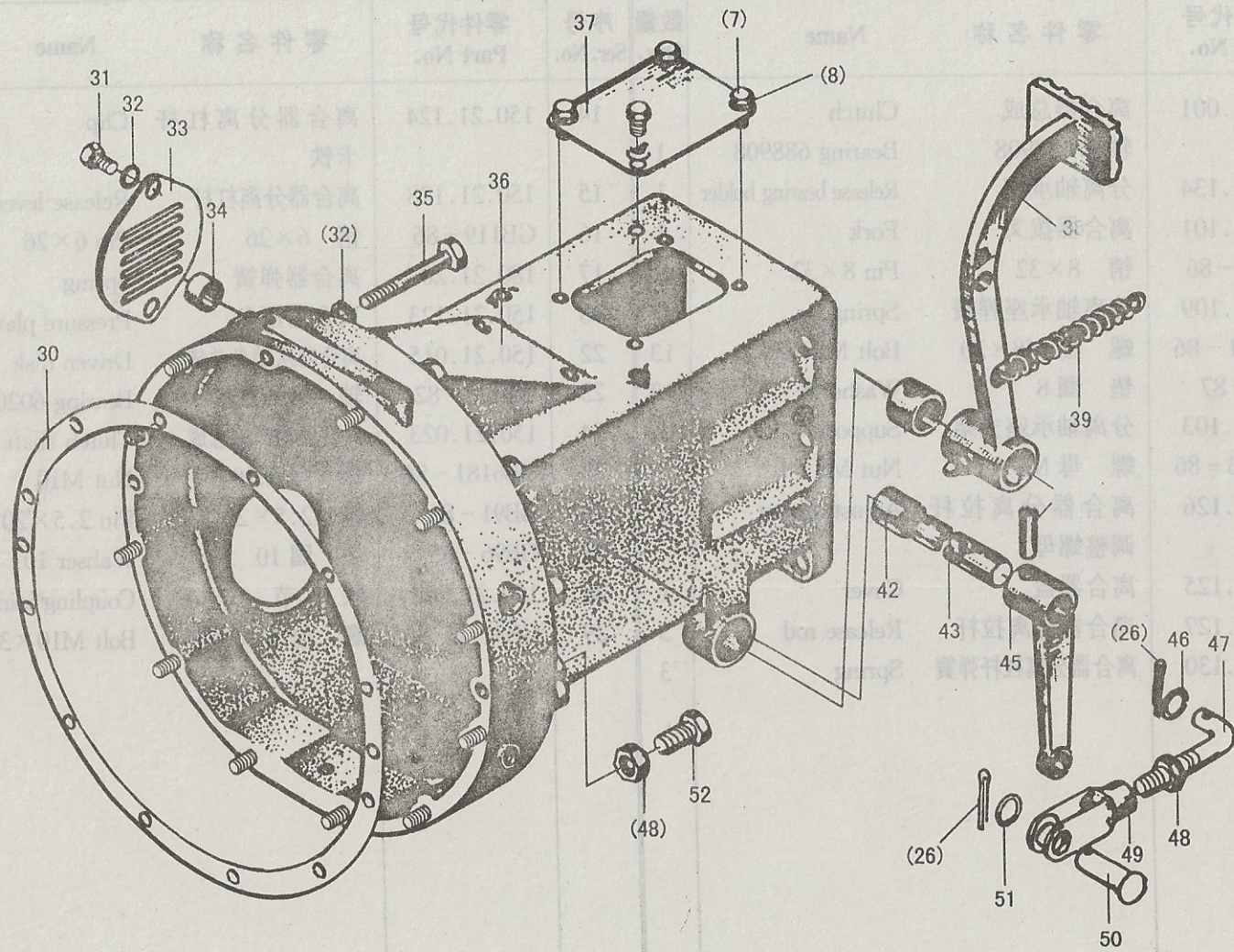
Fig.9 Drive Gearbox

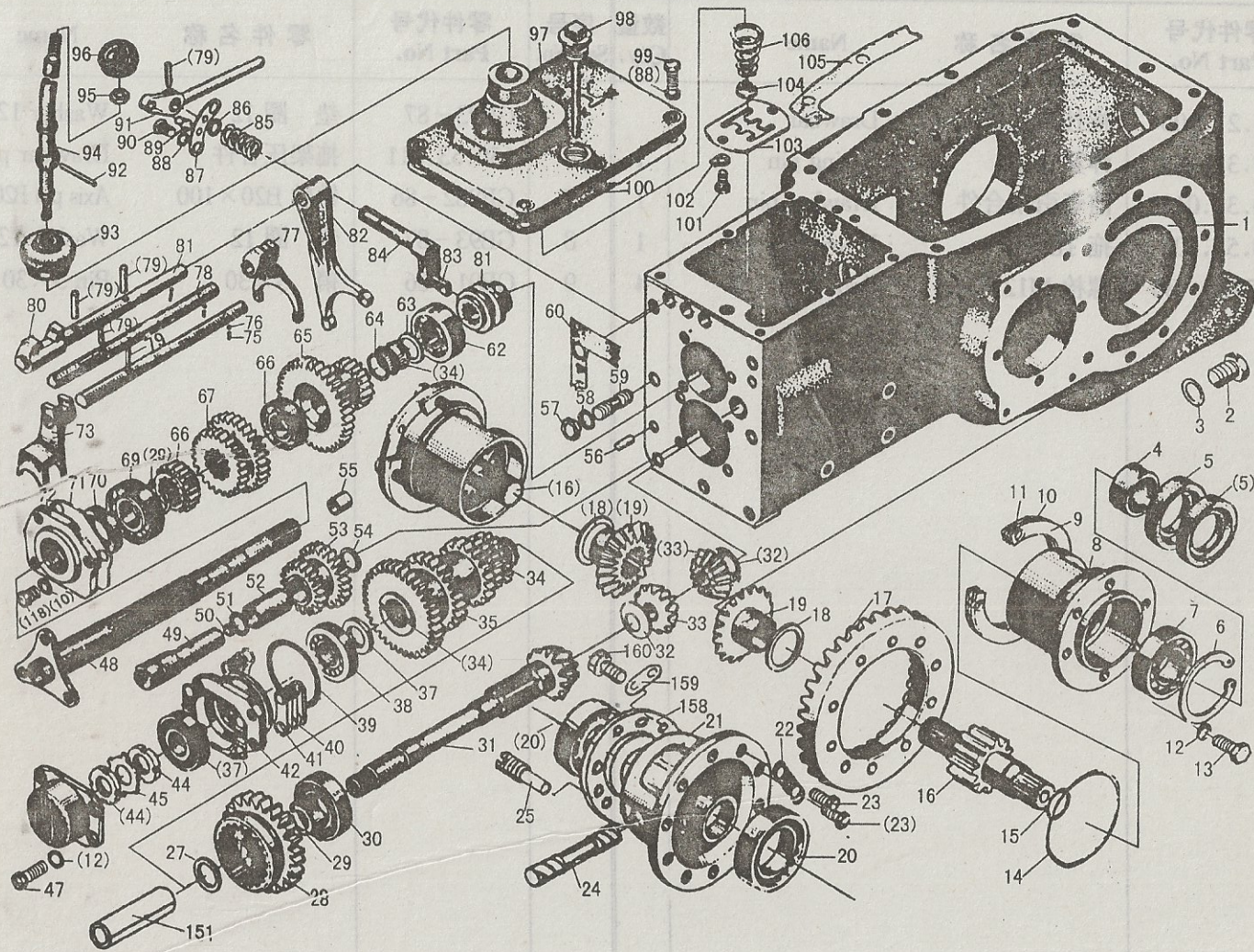

图 10. 转向器总成

Fig.10 Steering

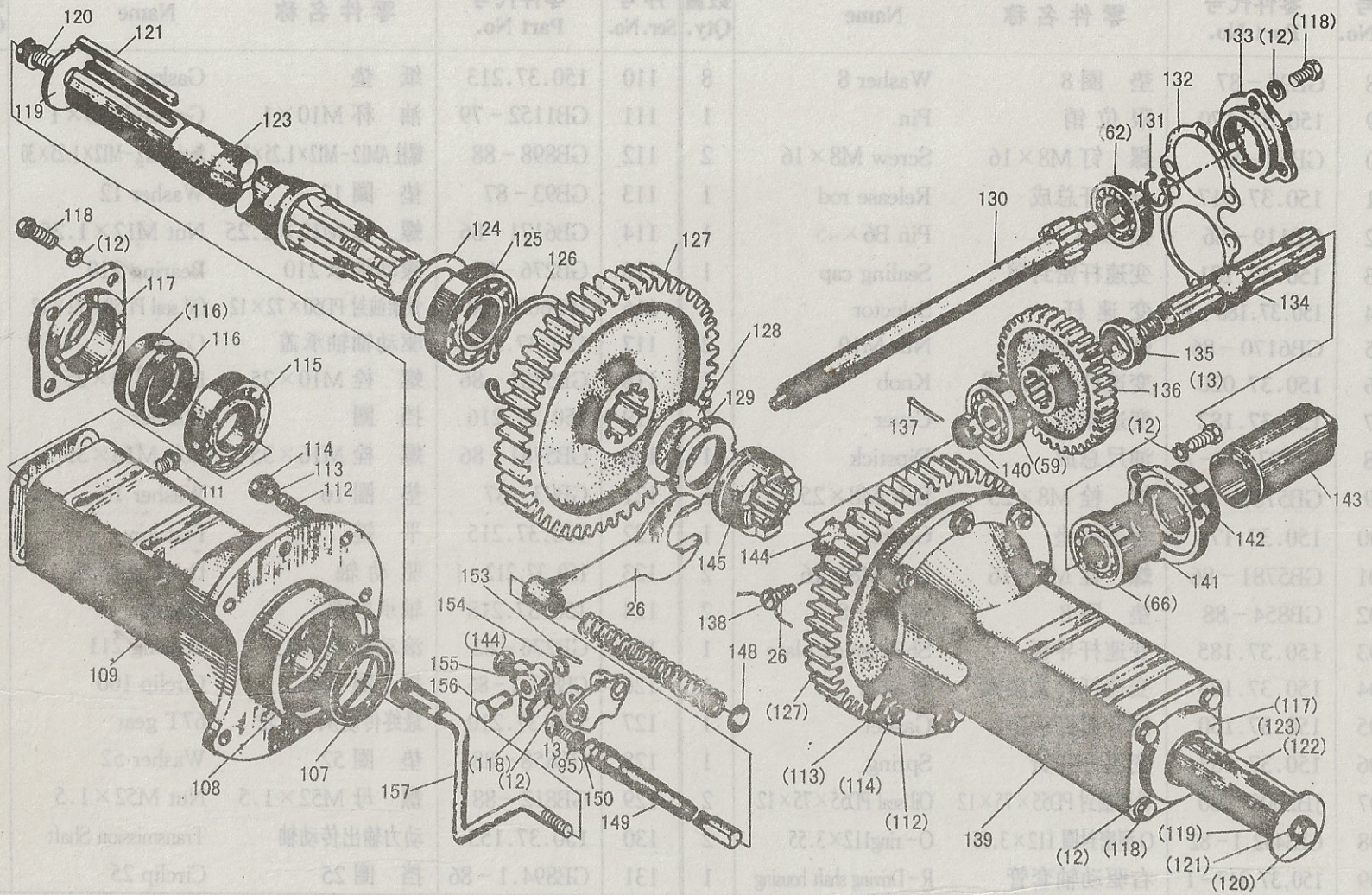

图 11. 制动器及操纵机构

Fig.11 Brake and Operation Mechanism



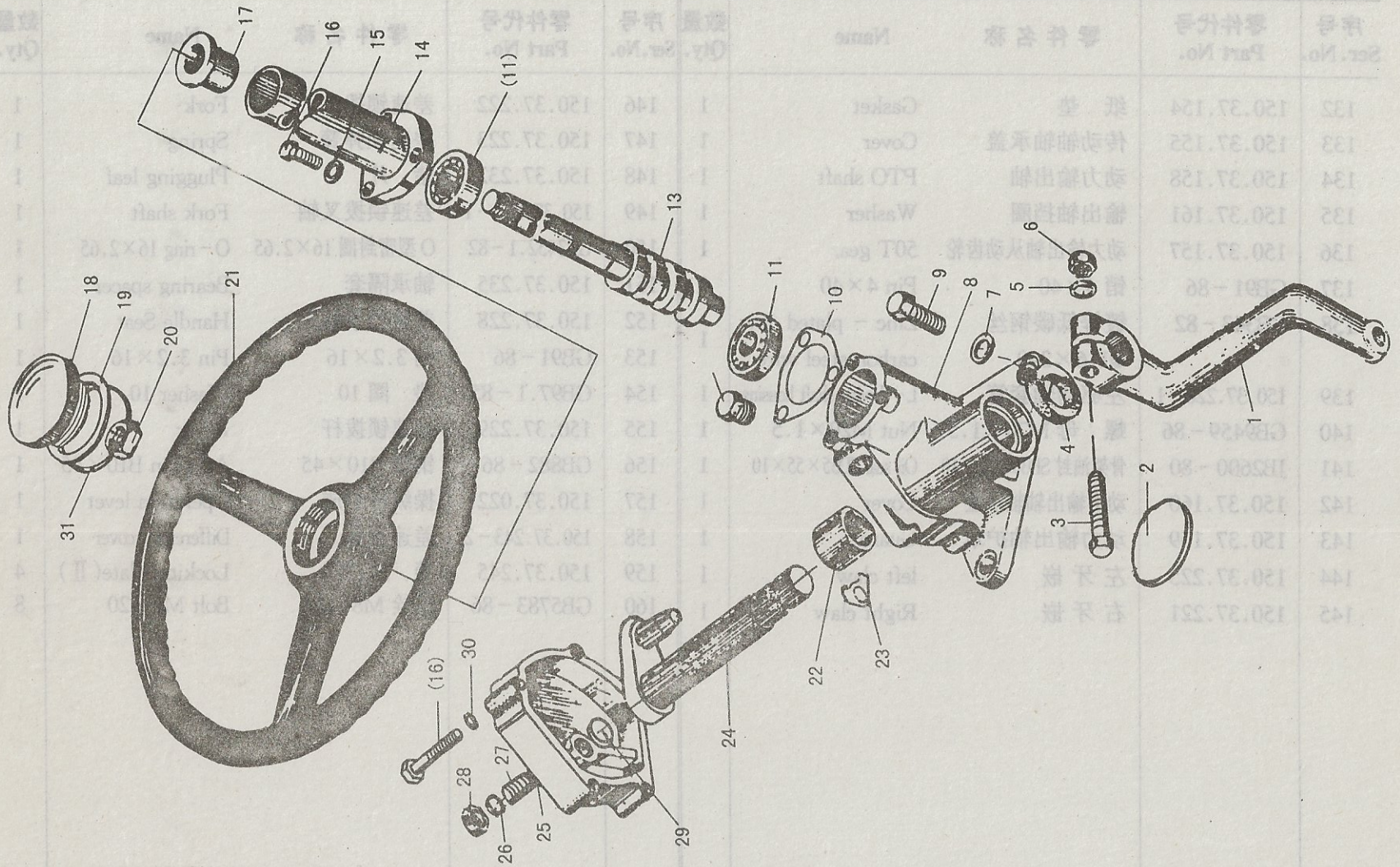

图 13. 机罩、仪表盘总成

Fig.13 Hood and panel Assembly

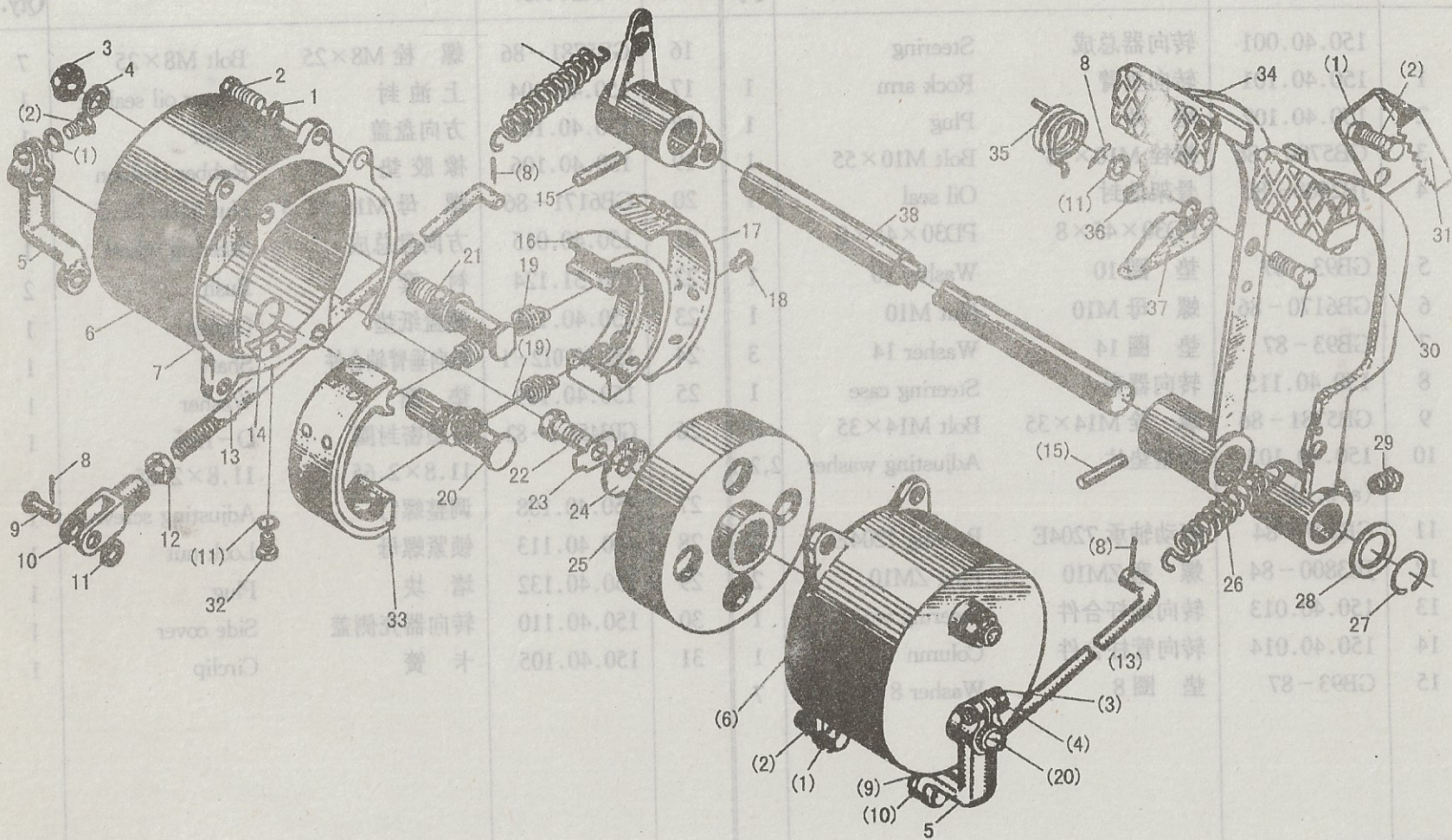

图 15. 电器设备和仪表 Fig.15 Electric Facilities and Instruments



图 17. 燃油箱总成 Fig.17 Fuel Tank

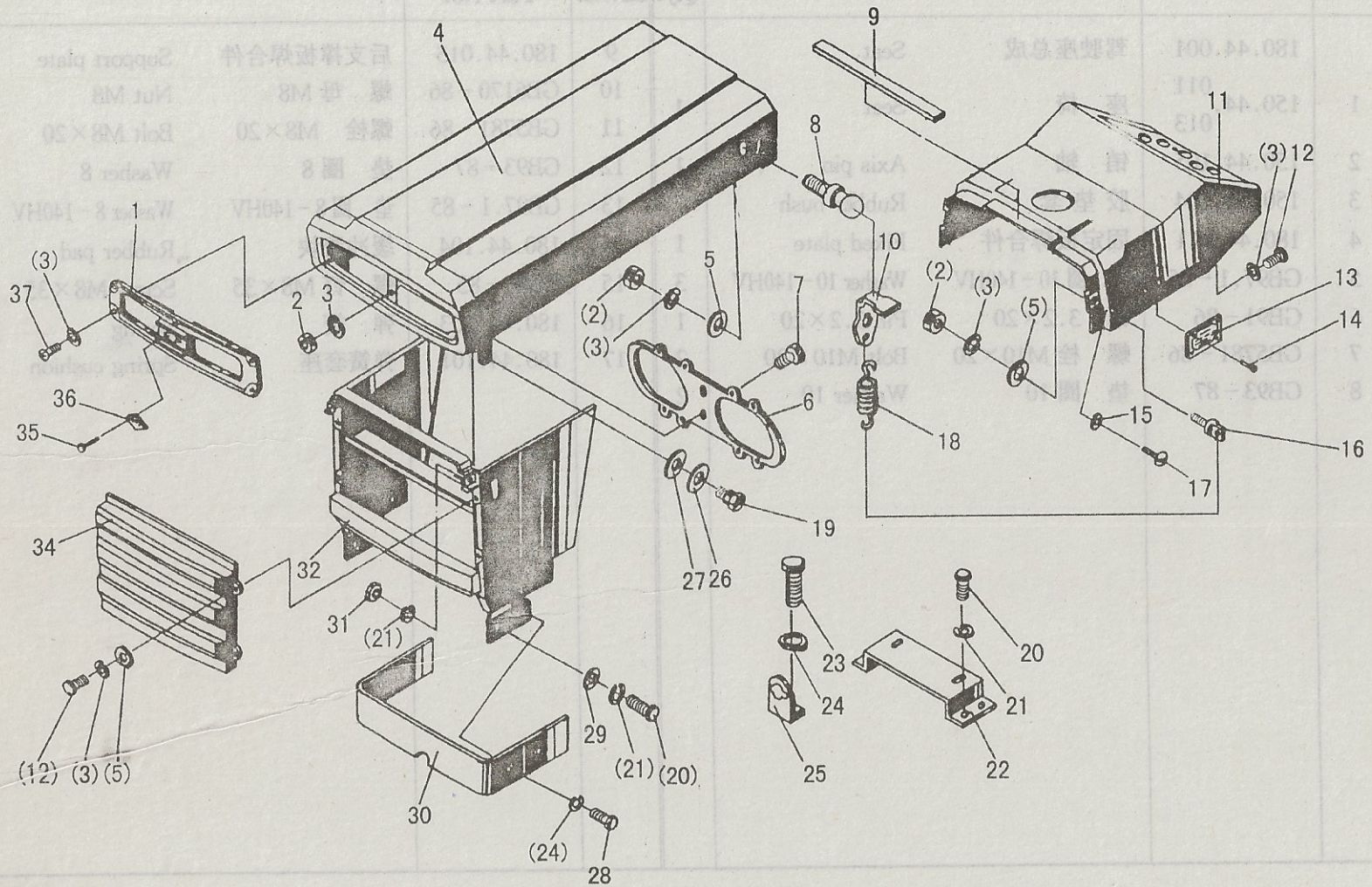

序号 Ser. No.	零件号 Part No.	零件名称 Name	数量 Qty.
1	150.49.001A	工具箱总成 Tool Box Assembly	1
2	150.49.111	1英寸 1 inch	2
		普通六角螺帽 Common Hex Nut	1
		普通六角螺栓 Common Hex Bolt	1
		Chain	2
		Box	1
		Pin	1

图 18. 液压油泵及管路总成

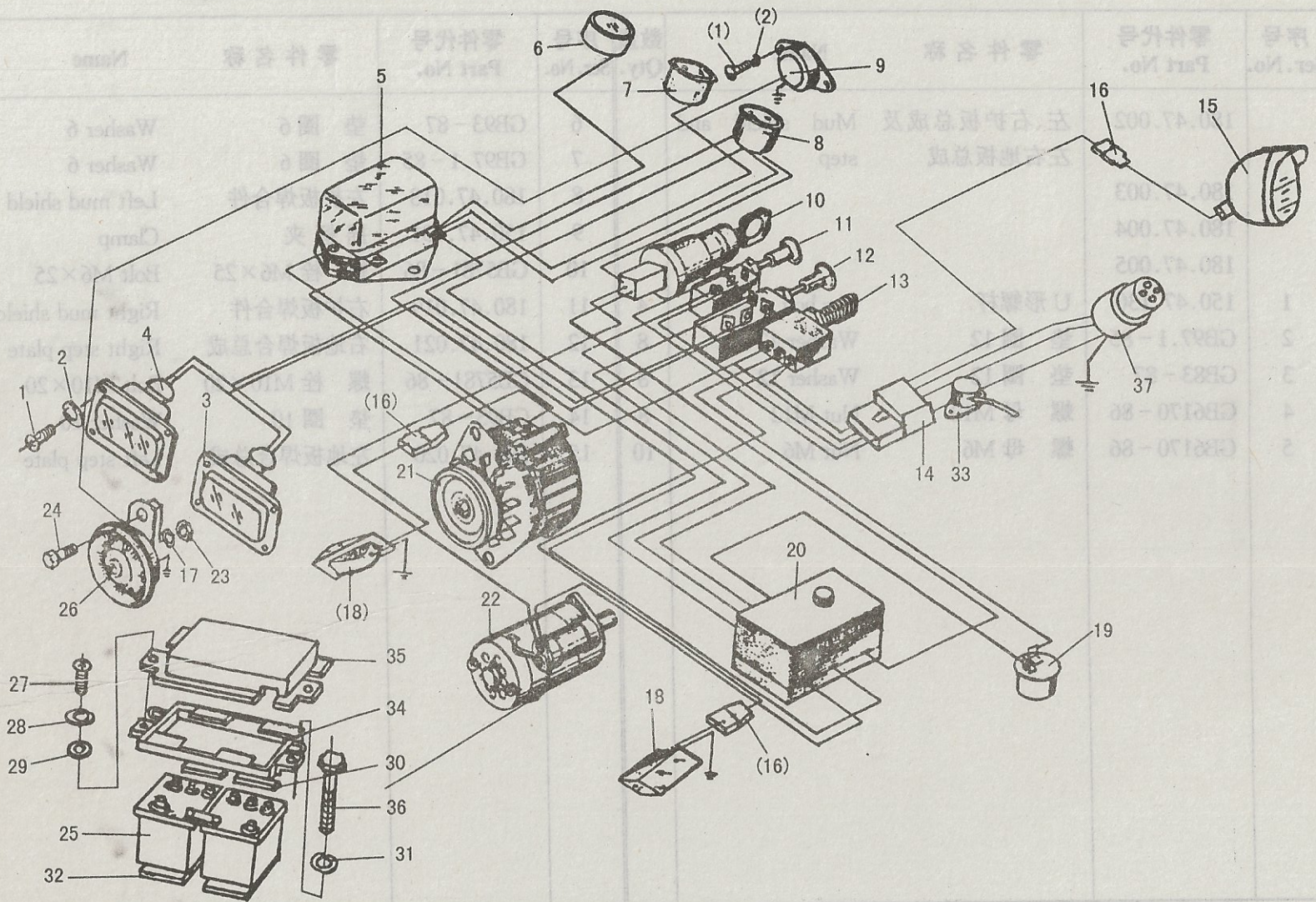
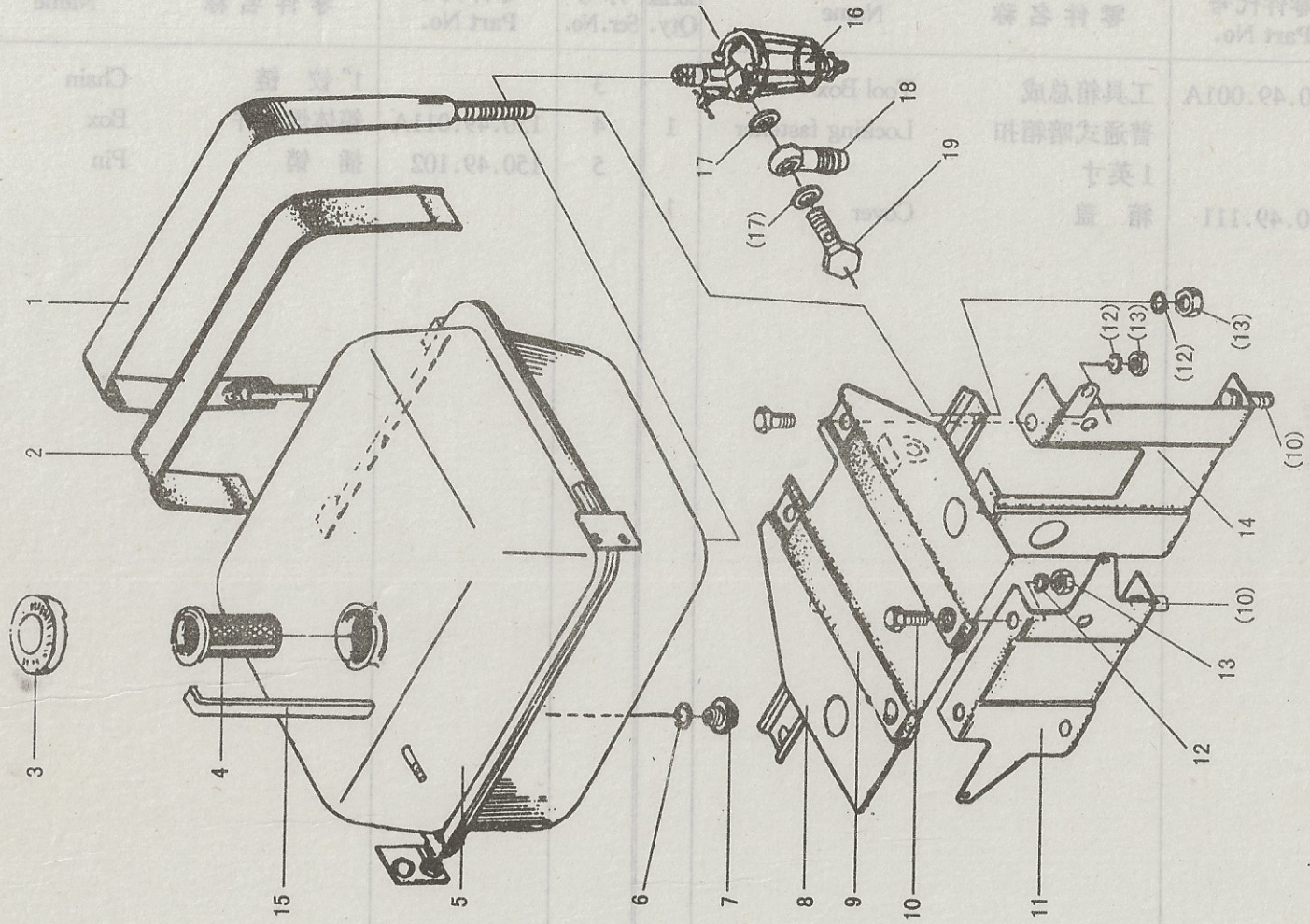
Fig.18 Pump and pipe







图 20. 悬挂机构总成

Fig.20 Suspension Mechanism

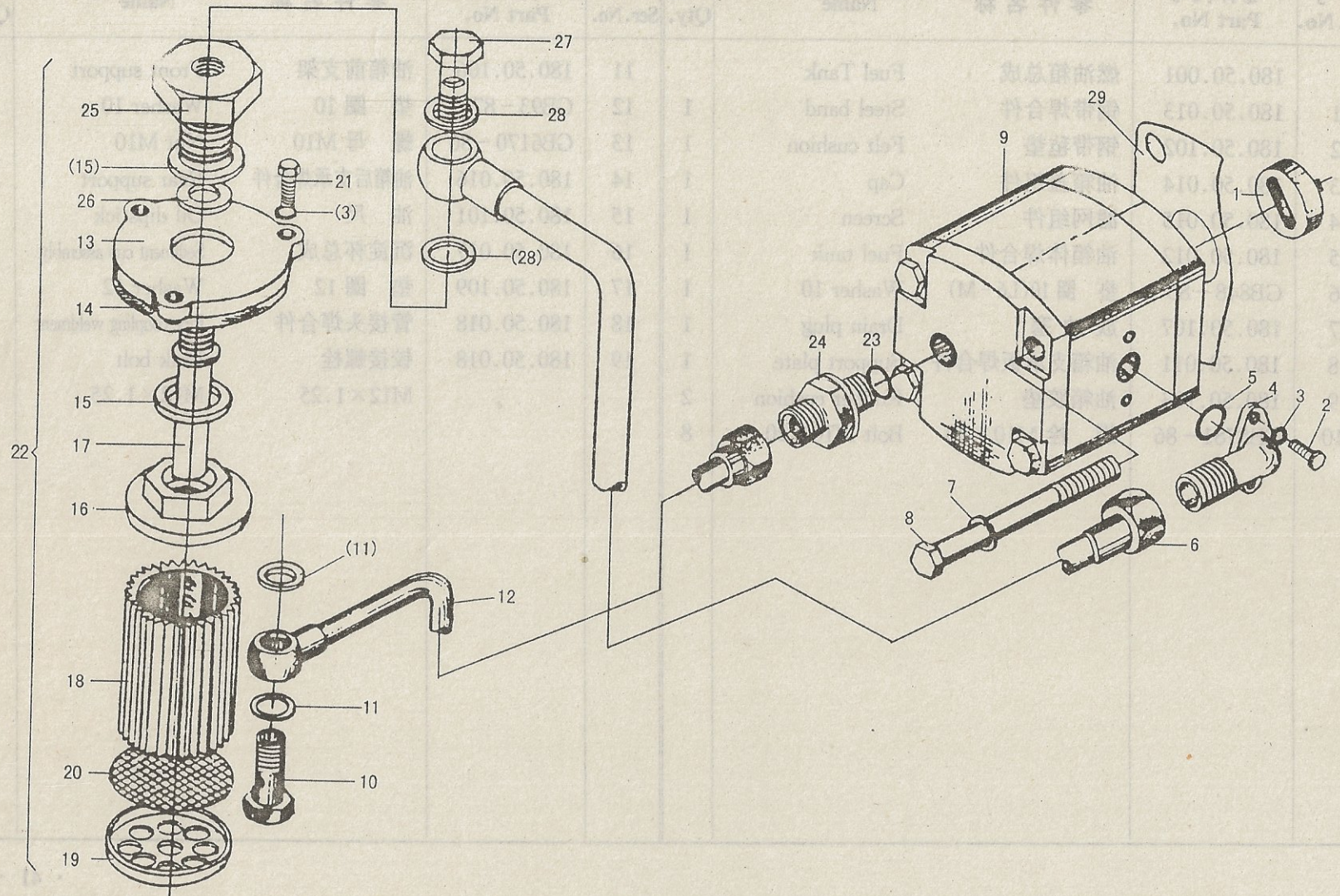

图 21. 分配器总成

Fig.21 Distributing Valve



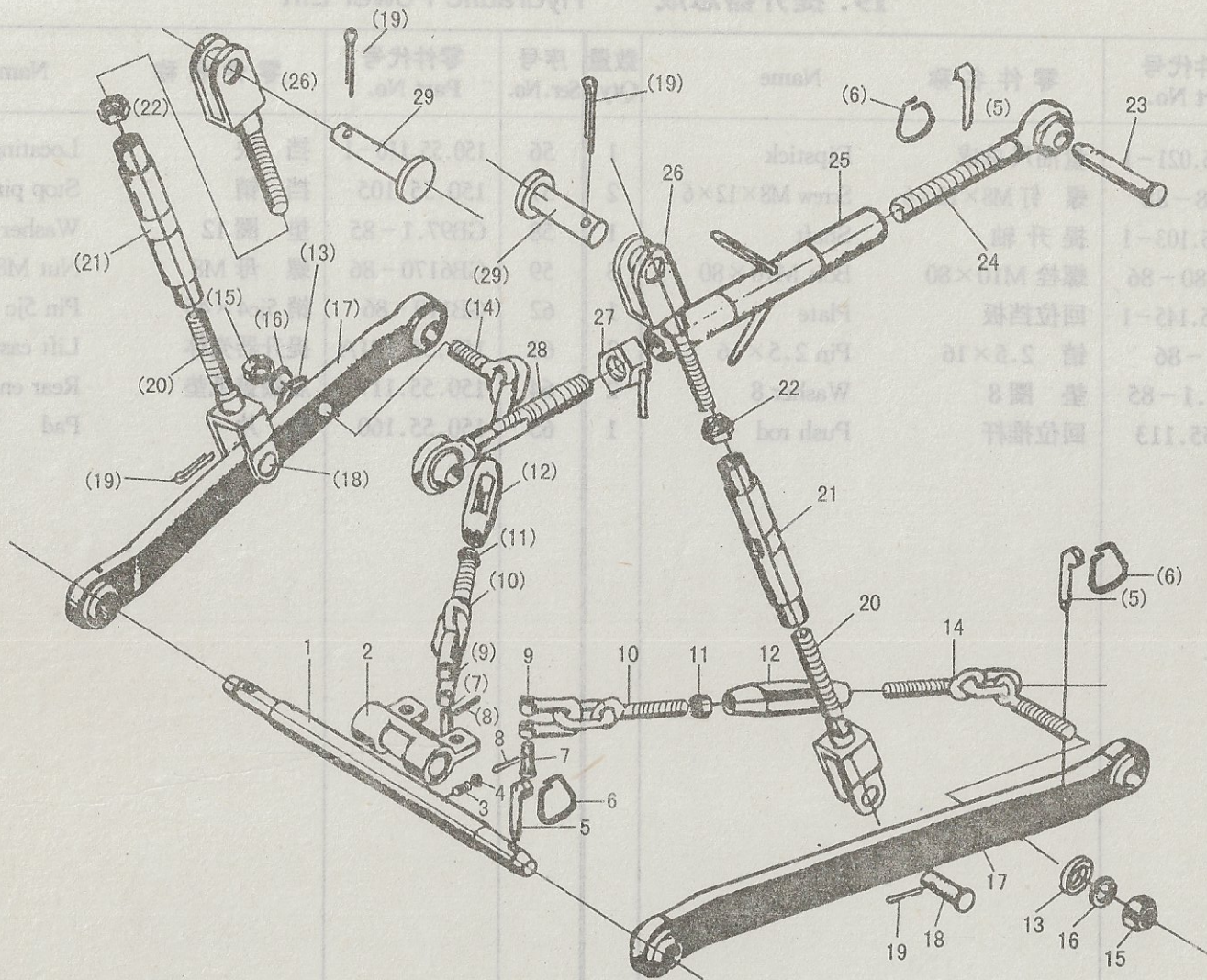

图 22. 180 拖车气制动总成

Fig.22 Vapour Brake Assembly of 180 Tractor

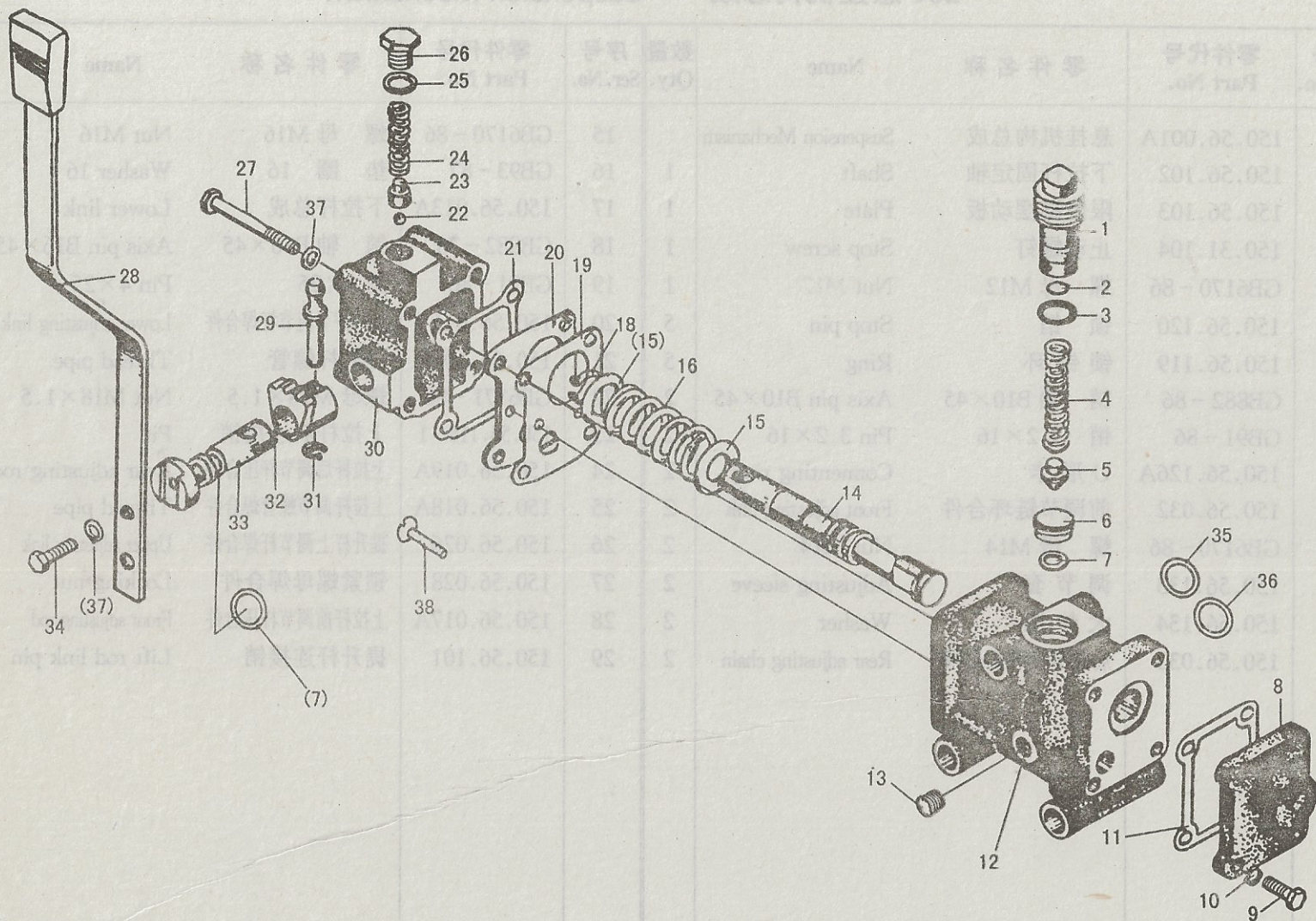

图 23. 前功率输出总成

Fig.23 Front Power Take - off

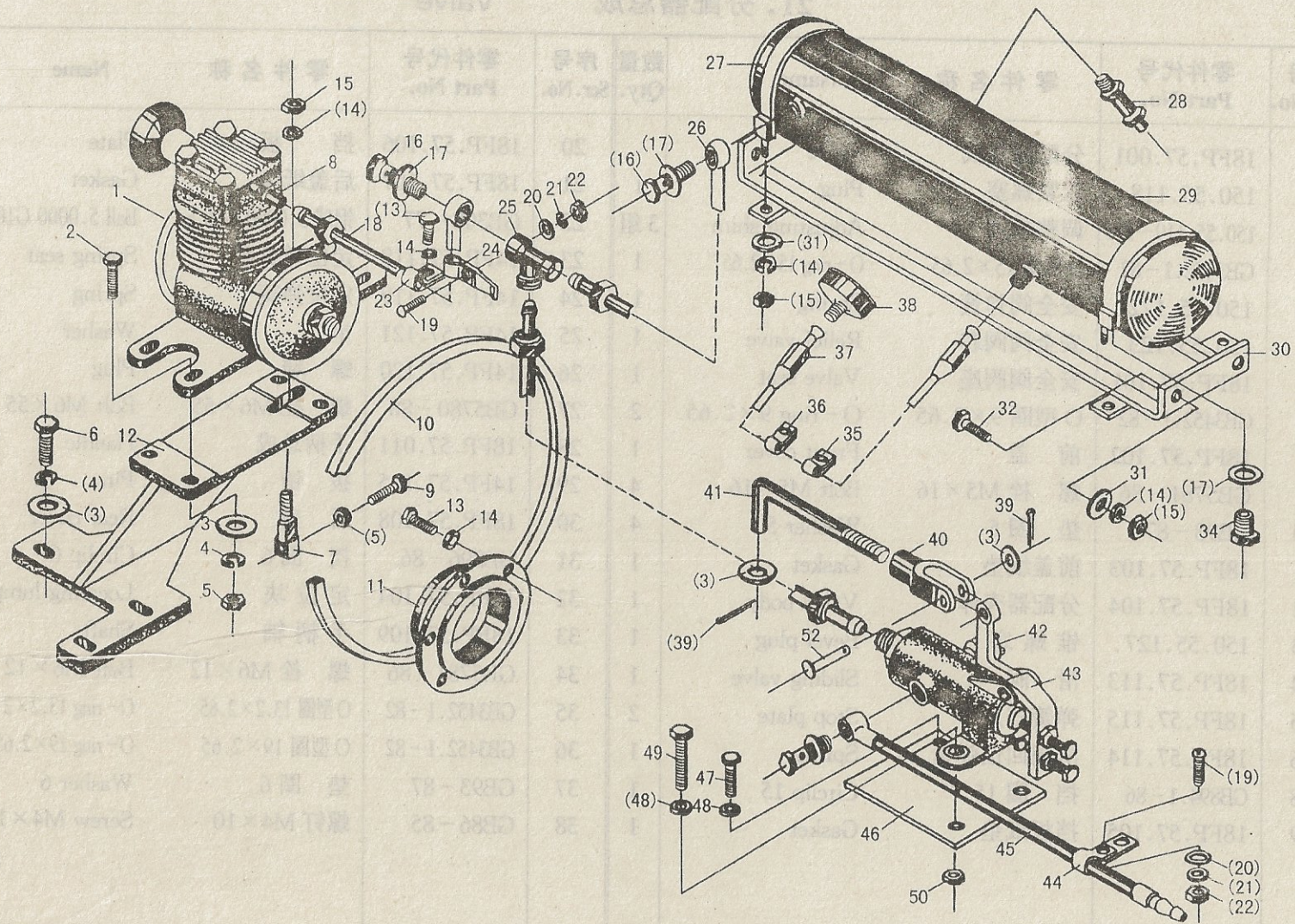